



Thank you for your registration for the **Critical Care Nursing** 10 week course to be held at the Mary Aikenhead Conference Centre, St Vincent's Hospital Melbourne. 27 Victoria Pde, Fitzroy. This is the closest entrance to Nicholson St. Take the first corridor to the left, the lecture theatre is on the right at the end of the corridor. Please see maps below and follow this link for a map of the surrounding area <http://goo.gl/maps/paQY3>

The course will be on Tuesday evenings from 6.30 pm to 9.30 pm and will run from the **1<sup>st</sup> May to 3rd July 2018**. On the first night of the course, **registration** will be from **5.45pm to 6.15pm** to allow the course to start promptly at 6.30pm. A substantial workbook of lecture outlines and selected references will be given to you at this time, for use during the ten weeks. A four colour pen will be given to you to assist with diagram and note taking. Tea and coffee will be available for early arrivals on the first night and refreshments will be provided midway through each evening.

**Car parking** may be available on the streets surrounding the hospital, or you can park in the hospital car parking stations, entry is via Fitzroy St and commercial rates apply. There is a Wilson carpark directly across the road from the Aikenhead Wing at 90 Victoria Parade, East Melbourne. We also recommend the Royal Exhibition/Melbourne museum car park off Nicholson Street. Parliament **train station** is about 500 meters walk. The tram lines serving St Vincent's Public Hospital are 11, 30, 86, 96, 109 and 112.

Additional brochures can be downloaded from our [website](#) if you would like to invite colleagues to attend the course with you.

If you have any questions, or would like further information, please contact us.

We look forward to seeing you at the seminar.

Yours sincerely, The Critical Care Education Services Team.

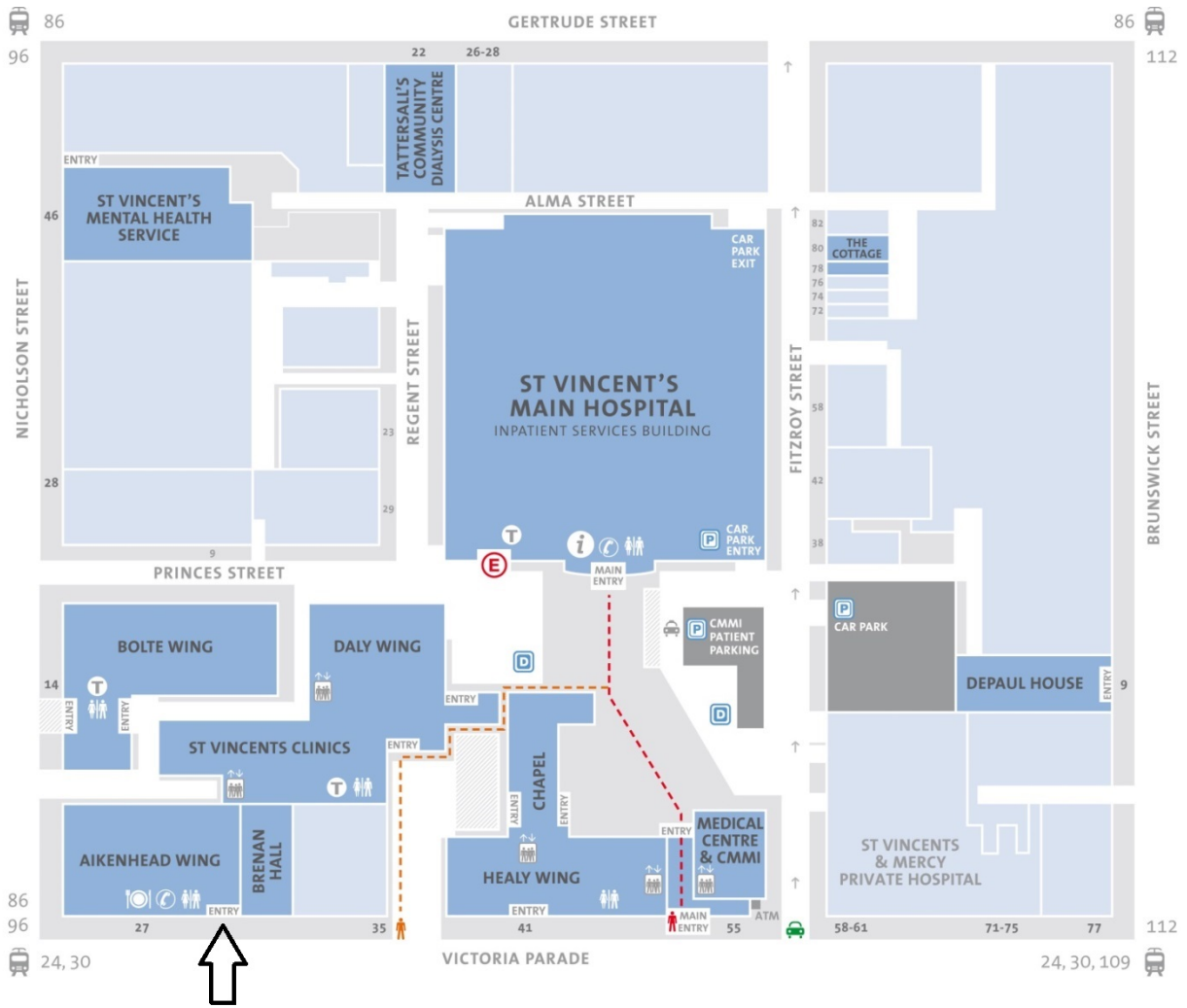

We are in this entrance

## Aikenhead Conference Centre

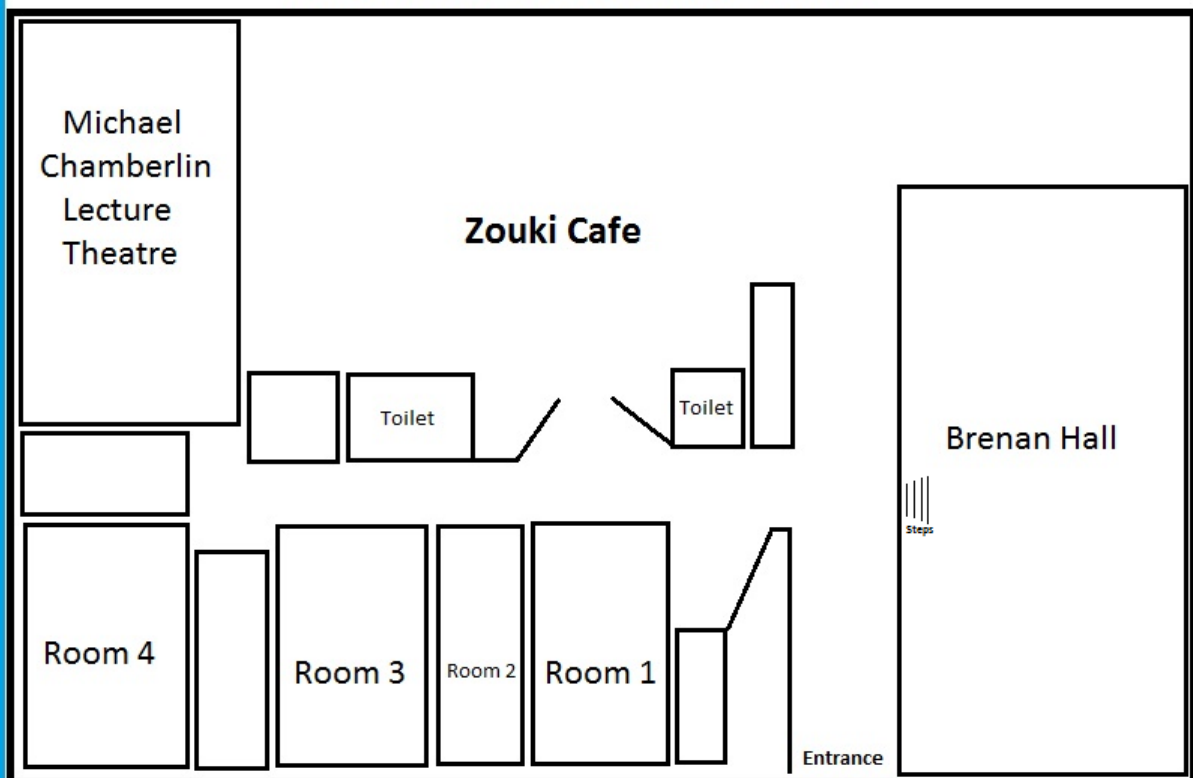

Victoria Pde