



Thank you for your recent course registration. The venue for the program is the Mary Aikenhead Conference Centre, **St Vincent's Hospital Melbourne**, 27 Victoria Pde, Fitzroy. The entrance is on Victoria Street and is the closest to Nicholson Street. It is easily identifiable by the bistro tables outside. Brennan Hall is located to the right up a small flight of stairs after you enter the building. Please see maps below and follow this link for a map of the surrounding area <http://goo.gl/maps/paQY3>

Registration will take place **between 8.15am and 8.45am** to allow the program to start promptly at 9am. At registration you will be given a workbook of lecture outlines with references and a four colour pen to aid note and diagram taking.

While attending the course you will be required to wear a name tag (supplied) to allow the hospital staff to identify our group for catering purposes, especially at lunch. This also makes it easy to remember the names of people you are meeting for the first time at the course. As you will be in an air-conditioned venue, we suggest that you dress in layers for comfort.

Car parking is available in the hospital private & public parking stations, entry is via Fitzroy St and commercial rates apply. There is a Wilson carpark directly across the road from the Aikenhead Wing at 90 Victoria Parade, East Melbourne. This car park has both weekend and early bird rates. We also recommend the Royal Exhibition/Melbourne museum car park off Nicholson Street. Parliament **train** station is about 500 meters walk. The **tram** lines serving St Vincent's Public Hospital are 11, 30, 86, 96, 109 and 112. Please note that trams running within the CBD are free.

If you are travelling some distance to attend the course, you may wish to arrange **accommodation** at one of the many CBD hotels. We have negotiated a special deal on accommodation at the Hotel Grand Chancellor; Executive Queen Room for \$162 per night or Executive King Room for \$172 per night. The King room can be split to have twin bedding at no extra cost. Simply advise the reservations team at the time of booking.

These rates include Hot buffet breakfast for 1 person daily (additional breakfasts are available for a discounted \$17 per person), in room Wi-Fi, 1 bottle of still water per day and Australian newspaper. Please head to the HGC website <http://www.grandchancellorhotels.com/> then select Melbourne and your dates of stay and enter the Promo/Corporate code CCES at the top of the screen. The discounted rate will now appear as an option, and you can proceed with the reservation. Alternatively, please contact the hotel reservations team on 03 9656 4000 and mention Critical Care Education Services to access this special rate.

Additional brochures can be downloaded from our [website](#) if you would like to invite colleagues to attend the course with you.

We look forward to seeing you at the course.

Yours sincerely, The Critical Care Education Services Team.

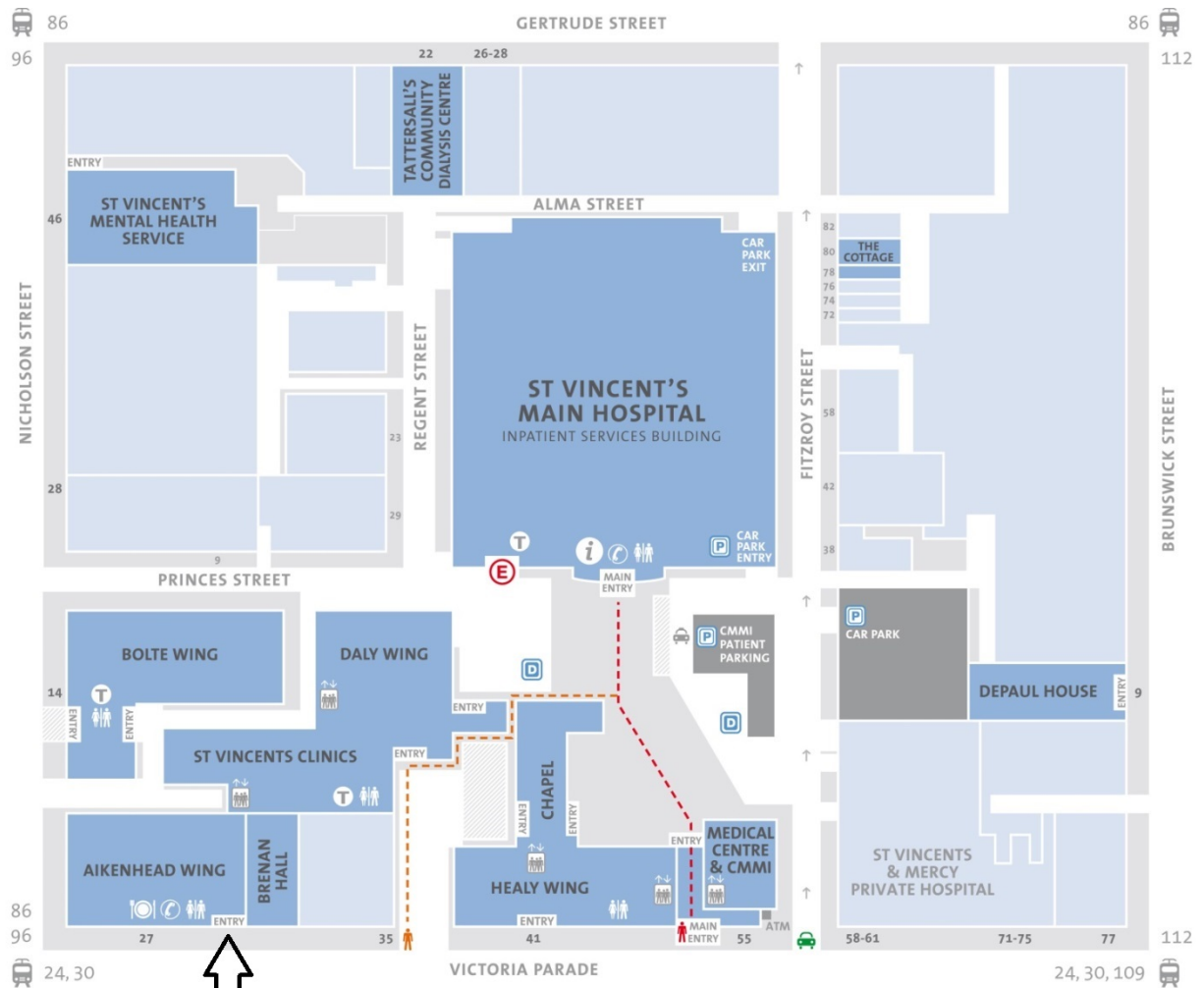

We are in this entrance

Aikenhead Conference Centre

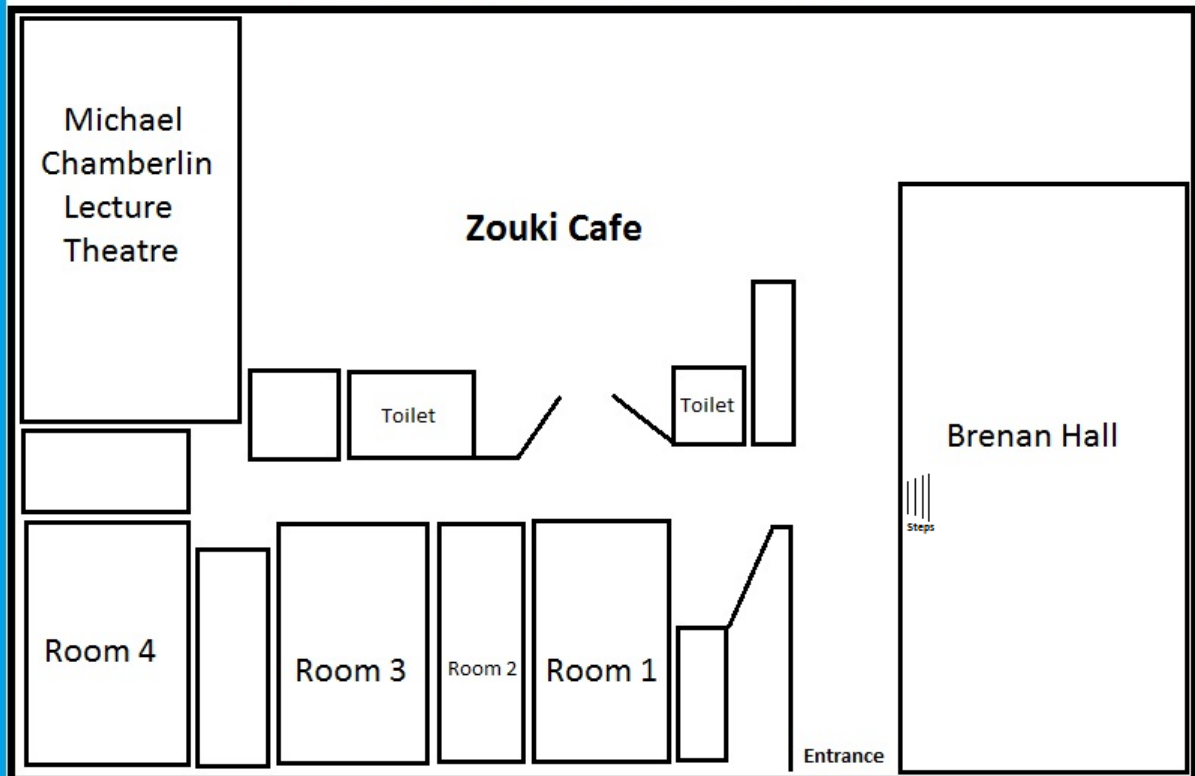

Victoria Pde